



Product update

ULTION | WXM

Still Ultion. now even stronger.

Why WXM?

The WXM shape was developed because it is symmetrical and as such creates a non-handed, 33% thicker key profile.



The **new** design is already trademark protected.

WXM also represents the major changes made to Ultion
-With Xtra Molybdenum.



Lockdown Mode gets a significant upgrade.

There are now TWO locking pins, which fire into the body of the locking pin rather than across it. All of the pins used in this area of the lock are made from hardened stainless steel 630.

These improvements mean that homeowners with Ultion WXM will be secured with Double Lockdown Mode.

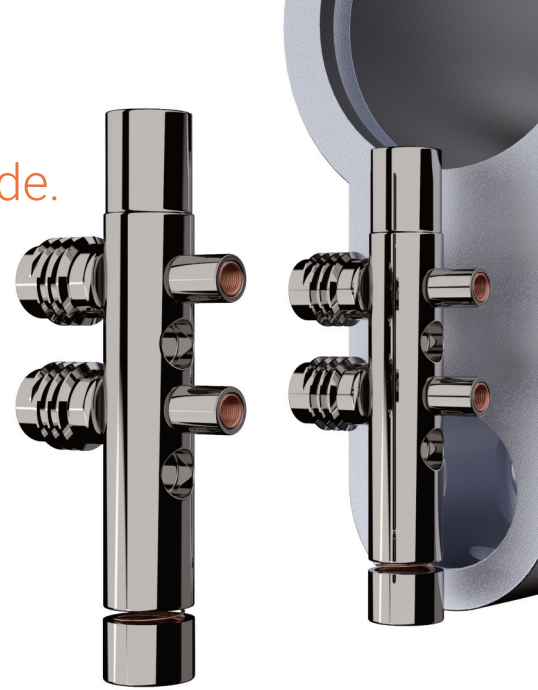

Stronger with extra molybdenum

The exclusive unique plug has been designed for Ultion WXM to address the ever increasing pressure on euro-cylinders with new door styles and multi-point locking systems. Brisant focussed on the key and where the plug engages with the clutch.

The now two-part plug has increased engagement with a new curved cap and the entire section is moulded from molybdenum and not brass. This strengthening is then coupled with the thicker WXM key shape and composition.

Improved drill protection has also been delivered with the new two-part plug in Ultion WXM. It still houses 20 anti-drill points, but the clutch is shielded with the molybdenum section of the plug.

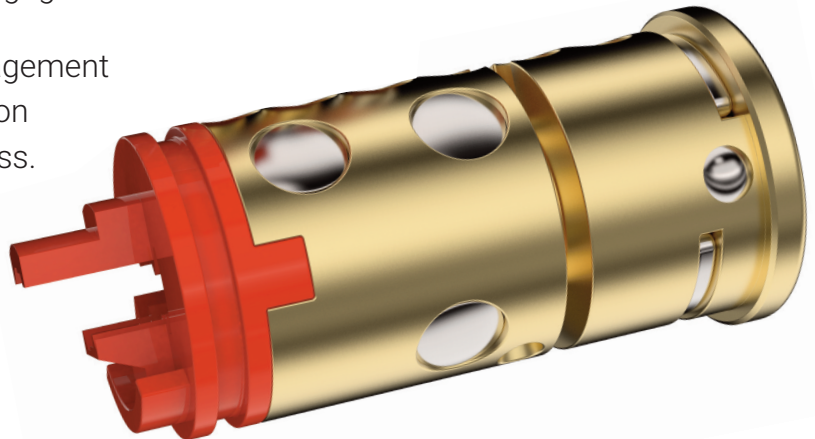

We believe Ultion is the most durable security euro-cylinder on the market.

Ultion WXM is harder to pick.

The thicker key has enabled the Brisant team to remove the 5 passive top pins and introduce two additional pin lengths to the lower active pins, whilst concurrently increasing the apex differentials between the heights, making the lock harder to pick.

The new pin heights produce in excess of 260,000 working differs, more than doubling the maximum requirement for TS007 3* grade 6.

For added picking protection Brisant will soon make two of the pins 'tapped' to create a false set during picking.

